

antenna

DATASHEET

# ADSS049

RF Adapter



# 1. Features

---

RF Adaptor to convert between SMA Male to SMA Female Right Angle Adaptor.

Durable connectors with >500 connect/disconnect cycles

Low insertion loss

# 2. General data

---

Electrical	
Impedance	50Ω
Frequency Range	DC ~ 18GHz
Working Voltage	1000V rms
Dielectric Withstanding Voltage	1500V(volts RMS)
Insulation Resistance	≥5000MΩ
VSWR	1.20:1
Durability	>500 cycles
Mechanical	
Connector Dimensions	17mm * 13mm
Connector 1 Type	SMA (M) Plug
Connector 2 Type	SMA (F) Jack
Environmental	
Hazardous Material Regulation	RoHS compliant
Operating Temperature	-40°C to +125°C

### 3. Part Number

Part Number – ADSS049

### 4. Drawing

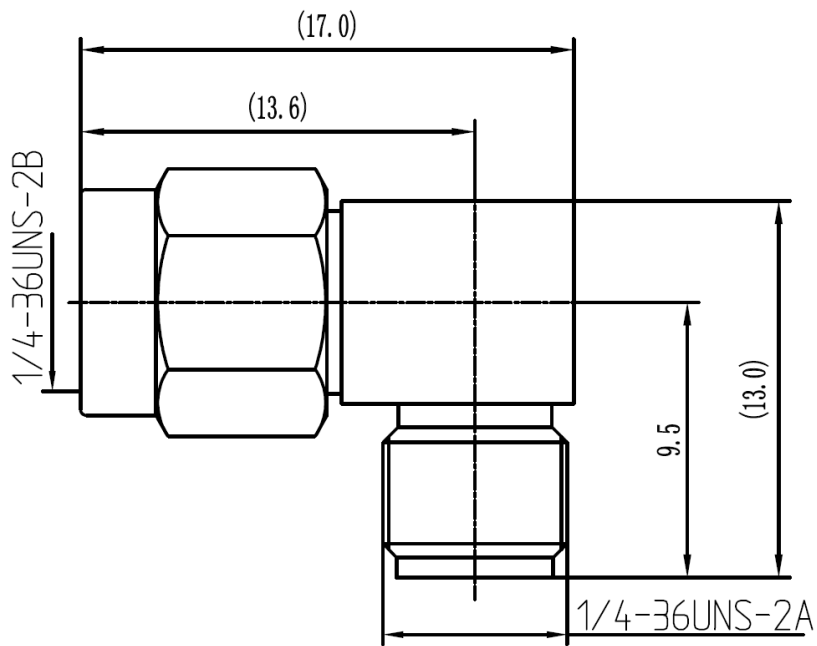

No	Description	Material	Finish	QTY
1	Body	Stainless Steel	Passivated	1
2	Insulator	Teflon	-	1
3	Contact pin	Beryllium-Copper	Gold Plated	1
4	Coupling nut	Stainless Steel	Passivated	1

## 5. Hazardous Material Regulation Conformance

---

The connector has been tested to conform to RoHS requirements.  
A certification of conformance is available from Antenova's website.

### Quality statements

Antenova's products conform to REACH and RoHS legislation. For our statements regarding these and other quality standards, please see [antenova.com](http://antenova.com).

Antenova reserves all rights to the contents of this document. Antenova gives no warranties based solely on the accuracy or completeness of the contents of this document and reserves the right to make changes to the specifications of the products described herein at any time and without notice.



---

### Datasheet version

1.01 release 11th July 2025

# Antenna design, integration and test resources

Product designers – the details contained in this datasheet will help you to complete your embedded antenna design. Please follow our technical advice carefully to obtain optimum antenna performance.

We aim to support our customers to create high performance wireless products. You will find a wealth of design resources, calculators and case studies to aid your design on our website. Antenova's design laboratories are equipped with the latest antenna design tools and test chambers. We provide antenna design, test and technical integration services to help you complete your design and obtain the required certifications.

If you cannot find the antenna you require in our product range, please contact us to discuss creating a custom antenna to meet your exact requirements.

Share knowledge with RF Experts around the world

ask.antenova is a global forum for designers and engineers working with wireless technology

[Visit Ask.Antenova](#)

Visit antenova.com

Order antenna samples and evaluation boards, and read our antenna resources

[Visit antenova.com](#)

Request a volume quotation for antennas:

[sales@antenova.com](mailto:sales@antenova.com)

+ 44 (0) 23 9400 1023

Global headquarters

Antenova Ltd, 7 The Briars,  
Waterberry Drive, Waterlooville,  
Hampshire, PO7 7YH